

Global Learning Conference Center

**Bldg #170, Georgia Institute of Technology
Room #317**
84 5th Street Northwest
Atlanta, Georgia 30308
Project # 183-2011

Hughes | Litton | Godwin

a Design Partnership

Architecture & Interior Design
1170 Peachtree Street, NE
Suite 225
Atlanta, GA 30309
404.760.7788
Contact: Cynthia Hovorka
Email: chovorka@hlgdesign.com
Phone: 404.499.7171

Hughes | Litton | Godwin
a Design Partnership

1170 Peachtree Street, NE
Suite 225
Atlanta, Georgia 30309
404.760.7788
Fax: 404.499.7171

This drawing is the property of HUGHES | LITTON | GODWIN and is not to be reproduced or copied in whole or in part. It is only to be used for the project and site specifically identified herein and is not to be used on any other project. All drawings are to be returned to HUGHES | LITTON | GODWIN if requested.

Global Learning Conference Center
Bldg #170, Georgia Institute of Technology, Room #317
84 5th Street Northwest
Atlanta, GA 30308

Mechanical Engineer
Georgia Institute of Technology
Facilities Design and Construction
955 Fowler Street, NW
Atlanta, GA 30332-0410
404.894.2097
Contact: Gregory Spiro
Email: greg.spiro@facilities.gatech.edu

Electrical Engineer
Georgia Institute of Technology
Facilities Design and Construction
955 Fowler Street, NW
Atlanta, GA 30332-0410
404.894.2097
Contact: Brian Clarke
Email: brian.clarke@facilities.gatech.edu

Client Project Manager
Georgia Institute of Technology
Facilities Design and Construction
955 Fowler Street, NW
Atlanta, GA 30332-0410
404.894.2097
Contact: Kim Wilson
Email: kim.wilson@facilities.gatech.edu

Client Interior Designer
Georgia Institute of Technology
Facilities Design and Construction
955 Fowler Street, NW
Atlanta, GA 30332-0410
404.894.4610
Contact: Polly Patton, RID
Email: polly.patton@facilities.gatech.edu

PROJECT INFORMATION

BUILDING ADDRESS: 84 5TH STREET NW
ATLANTA, GEORGIA 30308

OCCUPANCY TYPE: BUSINESS

CONSTRUCTION TYPE: TYPE II

SCOPE OF WORK: 654 USABLE SQUARE FOOTAGE

TOTAL NUMBER OF FLOORS: 1

PROJECT DESCRIPTION: EXECUTIVE CONFERENCE ROOM #315 RENOVATION

KEY PLAN

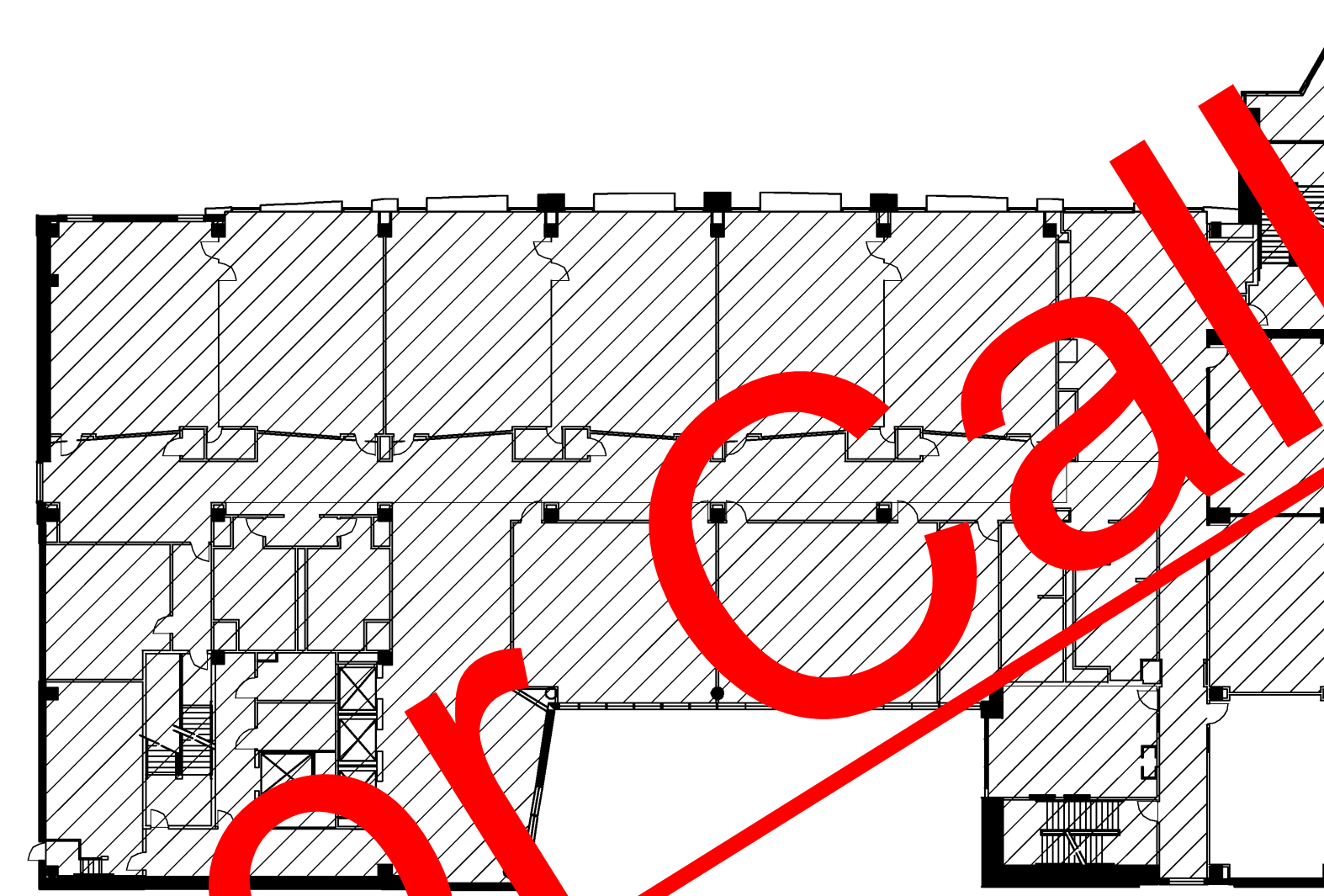

DRAWING INDEX

Issue	Date & Description	By
1	05/16/2011 FOR BID	CH

ARCHITECTURAL	
A00.00	COVER SHEET (DRAWING INDEX & PROJECT INFORMATION)
A00.10	GRAPHIC SYMBOLS LEGENDS
A00.20	GENERAL NOTES
A01.03	THIRD FLOOR DEMOLITION PLAN
A02.03	THIRD FLOOR PLAN
A03.03	THIRD FLOOR POWER & COMMUNICATION PLAN
A04.03	THIRD FLOOR REFLECTED CEILING PLAN
A05.03	THIRD FLOOR FINISH PLAN
A06.03	THIRD FLOOR FURNITURE PLAN
A11.00	ELEVATIONS
A11.01	ELEVATIONS
A12.00	CEILING DETAILS
A12.01	MILLWORK DETAILS
ELECTRICAL	
E-1	ROOM 317 DEMO, POWER AND LIGHTING
DATA	
T-1	ROOM 317 TELECOM PLAN
AUDIO / VISUAL	
EAV1.1	AV INFRASTRUCTURE PLAN AND RCP
EAV1.2	AV INFRASTRUCTURE DETAILS

APPLICABLE CODES

BUILDING CODE: INTERNATIONAL BUILDING CODE (IBC), 2006 EDITION WITH GEORGIA STATE AMENDMENTS (2007), (2009) & (2010)

SAFETY CODE: NATIONAL FIRE PROTECTION ASSOCIATION (NFPA) 101 LIFE SAFETY CODE, 2000 EDITION AS AMENDED

FIRE CODE: INTERNATIONAL FIRE CODE (IFC), 2006 EDITION WITH GEORGIA STATE AMENDMENTS (2007) & (2010)

ACCESSIBILITY CODE: GEORGIA HANDICAPPED ACCESSIBILITY LAW 120-3-20

MECHANICAL CODE: INTERNATIONAL MECHANICAL CODE (IMC), 2006 EDITION WITH GEORGIA STATE AMENDMENTS (2007), ERRATA TO 2007 AMENDMENTS, (2008), (2010) & (2011)

ELECTRICAL CODE: NATIONAL ELECTRICAL CODE, 2008 EDITION WITH GEORGIA AMENDMENTS (2009)

PLUMBING CODE: INTERNATIONAL PLUMBING CODE (IPC), 2006 EDITION WITH GEORGIA STATE AMENDMENTS (2007), (2008), (2009), (2010) & (2011)

GAS CODE: INTERNATIONAL FUEL GAS CODE (IFGC), 2006 EDITION WITH GEORGIA STATE AMENDMENTS (2007), (2008), (2009) & (2010)

ENERGY CONSERVATION CODE: INTERNATIONAL ENERGY CONSERVATION CODE (IECC), 2009 EDITION WITH GEORGIA SUPPLEMENTS AND AMENDMENTS (2011)

See/Signature

Project
Global Learning Conference Center, Bldg #170
Georgia Institute of Technology, Room #317

Project Number
#183-2011 / 11.001.01 (HLG)

File Name
A00-00.DWG

Description
COVER SHEET

Scale

Sheet Number

A00.00

www.SuperiorReprographics.com or Call 770-944-7293

GRAPHIC SYMBOLS

FLOOR PLAN

- 1 COLUMN GRID
- A COLUMN GRID
- EXISTING CONSTRUCTION TO REMAIN
- EXISTING CONSTRUCTION TO BE DEMOLISHED
- NEW PARTITION
- REFERENCE TO PARTITION TYPE
- RATED PARTITION
- REFERENCE TO PARTITION TYPE
- ELEVATION DATUM POINT
- ROOM NAME
- ROOM NUMBER
- DOOR NUMBER (SEE SCHEDULE)
- ALIGN
- KEY SITE
- ELEVATION NUMBER SHEET WHERE SHOWN
- SHEET WHERE SHOWN
- ELEVATION NUMBER
- DETAIL NUMBER
- SHEET WHERE SHOWN
- AREA TO BE DETAILED
- FIRE HOSE CABINET
- FIRE EXTINGUISHER WITHOUT CABINET
- FIRE EXTINGUISHER CABINET
- FIRE VALVE WITHOUT CABINET
- FIRE VALVE CABINET

POWER & COMMUNICATION

- WALL MOUNTED DUPLEX
- WALL MOUNTED DEDICATED DUPLEX
- WALL MOUNTED SEPARATE DUPLEX
- WALL MOUNTED DEDICATED FOURPLEX
- WALL MOUNTED HALF DEDICATED FOURPLEX
- WALL MOUNTED SPECIAL OUTLET
- WALL MOUNTED TELEPHONE RECEPTACLE
- WALL MOUNTED TELE/DATA RECEPTACLE
- WALL MOUNTED DATA RECEPTACLE
- WALL MOUNTED A/V RECEPTACLE
- WALL MOUNTED TV RECEPTACLE
- FLUSH FLOOR MOUNTED TELEPHONE RECEPTACLE
- FLUSH FLOOR MOUNTED TELE/DATA RECEPTACLE
- FLUSH FLOOR MOUNTED DATA RECEPTACLE
- FLUSH FLOOR MOUNTED DUPLEX
- FLUSH FLOOR MOUNTED FOURPLEX
- FLUSH FLOOR MOUNTED DEDICATED DUPLEX
- FLUSH FLOOR MOUNTED DEDICATED FOURPLEX
- FLUSH FLOOR MOUNTED SEPARATE DUPLEX
- FLUSH FLOOR MOUNTED SEPARATE FOURPLEX
- FLUSH FLOOR MOUNTED DUPLEX WITH TELE/DATA RECEPTACLE
- FLUSH FLOOR MOUNTED DEDICATED DUPLEX WITH TELE/DATA RECEPTACLE
- FLUSH FLOOR MOUNTED SEPARATE DUPLEX WITH TELE/DATA RECEPTACLE
- FLUSH FLOOR MOUNTED SEPARATE FOURPLEX WITH TELE/DATA RECEPTACLE
- POKE-THRU TELE/DATA MONUMENT
- POKE-THRU DATA POWER MONUMENT
- POKE-THRU DUPLEX POWER MONUMENT
- POKE-THRU FOURPLEX POWER MONUMENT
- POKE-THRU DEDICATED DUPLEX POWER MONUMENT
- POKE-THRU DEDICATED FOURPLEX POWER MONUMENT
- POKE-THRU SEPARATE DUPLEX POWER MONUMENT
- POKE-THRU SEPARATE FOURPLEX POWER MONUMENT
- POKE-THRU A/V MONUMENT
- POKE-THRU TV MONUMENT
- FLUSH WALL MOUNTED POWER JUNCTION BOX WITH HARDWARE CONNECTION

GRAPHIC SYMBOLS

POWER & COMMUNICATION CONT.

- FLOOR POKE-THRU JUNCTION BOX WITH HARDWARE CONNECTION
- COMBINATION FLOOR POKE-THRU JUNCTION BOX WITH HARDWARE CONNECTION
- CARD READER
- INTERCOM DEVICE
- DOOR RELEASE BUZZER
- DOOR BELL PUSH BUTTON
- DOOR BELL
- ELECTROMAGNETIC DOOR HOLD OPEN
- ELECTRIC LOCKSET (SEE HARDWARE SCHEDULE)
- MAGNETIC LOCK (SEE HARDWARE SCHEDULE)
- SECURITY SYSTEM DOOR MONITOR CONTACT (SEE HARDWARE SCHEDULE)
- INTRUSION ALARM (SEE SECURITY DRAWINGS)
- KEY SWITCH (SEE SECURITY DRAWINGS)
- EQUIPMENT ITEM - SEE SCHEDULE
- POWER POLE
- FIRE WARDEN STATION
- FIRE ALARM PULL BOX

REFLECTED CEILING

- MANUF: ARMSTRONG
- STYLE: OPTIMA
- ITEM #: 3152
- COLOR: WHITE
- GRID FACE: 15/16"
- EDGE PROFILE: SQUARE LAY-IN
- SIZE: 2' X 2' X 1"
- MANUF: ARMSTRONG
- STYLE: OPTIMA
- ITEM #: 3162
- COLOR: WHITE
- GRID FACE: 15/16"
- EDGE PROFILE: SQUARE LAY-IN
- SIZE: 2' X 8' X 1"
- ACCESSORIES: ITEM 435, STABILIZER CLIP
- NOTE: PANELS 8' AND OVER - TWO CLIPS INSTALLED AT ONE-THIRD POINTS OF EACH LONG EDGE.
- UNDER CABINET FLUORESCENT FIXTURE
- 4" LED RECESSED DOWNLIGHT
- 4" LED RECESSED DOWNLIGHT
- 3" LED STRIP FIXTURE
- 4" LED STRIP FIXTURE
- 5" LED STRIP FIXTURE
- 6" LED STRIP FIXTURE
- DIMENSION OF CEILING ABOVE FINISH FLOOR
- CEILING FINISH
- CEILING MOUNTED EXIT SIGN
- RECESSED WALL WASHER
- TRACK LIGHTING
- SURFACE MOUNTED LIGHT FIXTURE
- WALL SCONCE
- EXHAUST FAN
- SMOKE DETECTOR
- STROBE
- FIRE SPRINKLER
- SPEAKER
- MOTION DETECTOR
- ACCESS DOOR
- SECURITY NAME
- THERMOSTAT
- LIGHT SWITCH
- DIMMER
- PROJECTOR SWITCH
- REJECTION SCREEN
- RETURN AIR
- SUPPLY AIR
- CIRCULAR DIFFUSER
- CLOCK OUTLET
- Denotes EXISTING TO REMAIN
- Denotes EXISTING, RELOCATED FIXTURE

FINISH

- WALL FINISH
- BASE FINISH
- EXTENT OF FINISH
- WALL FINISH
- EXTENT OF FINISH
- FLOOR FINISH
- CHANGE IN FLOOR FINISH
- INDICATES DIRECTION OF WOOD GRAIN OR PATTERN

Hughes | Littin | Godwin

117 Peachtree Street, NE
Atlanta, Georgia 30309
404.762.7788
Fax 404.460.7187

This drawing is the property of HUGHES | LITTON | GODWIN and is not to be reproduced or copied in whole or in part. It is only to be used for the project and site specifically identified herein and is not to be used on any other project. All drawings are to be returned to HUGHES | LITTON | GODWIN if requested.

Global Learning Conference Center
Bldg #170, Georgia Institute of Technology, Room #317
84 5th Street Northwest
Atlanta, GA 30308

Issue	Date & Description	By
1	05/16/2011 FOR BID	CH

See/Signature

Project: Global Learning Conference Center, Bldg #170 Georgia Institute of Technology, Room #317

Project Number: #183-2011 / 11.001.01 (HLG)

File Name: A00-01.DWG

Description: GRAPHIC SYMBOLS LEGENDS

Scale:

Sheet Number: **A00.10**

P:\11001\01\11001\001\Sheets\A00-01.dwg May 16, 2011 09:35am sferns

Order Plans @
www.SuperiorReprographics.com
or Call
770-944-7293

KEY NOTES

- 1 REMOVE EXISTING WALL-MOUNTED MARKER BOARDS. PATCH AND REPAIR WALL AS REQUIRED.
- 2 REMOVE AND REPLASTER FABRIC WALL PANELS. REPAIR TO FINISH LEGEND FOR SADDLE SPECIFICATION. PATCH AND REPAIR WALL AS REQUIRED.
- 3 REMOVE EXISTING CARPET TO CENTER LINE OF DOOR THRESHOLD.
- 4 REMOVE EXISTING WINDOW BLINDS.
- 5 REMOVE WALL HOOK AT EXISTING CLOCK.

Hughes | Litton | Godwin
Design Partnership

117 Peachtree Street, NE
Suite 3000
Atlanta, Georgia 30309
404.762.7788
Fax 404.760.7187

This drawing is the property of HUGHES | LITTON | GODWIN and is not to be reproduced or copied in whole or in part. It is only to be used for the project and site specifically identified herein and is not to be used on any other project. All drawings are to be returned to HUGHES | LITTON | GODWIN if requested.

Global Learning Conference Center

Bldg #170, Georgia Institute of Technology, Room #317
84 8th Street Northwest
Atlanta, GA 30306

Issue	Date & Description	By
1	05/16/2011 FOR BID	CH

SHEET NOTES

- A. REMOVE ALL EXISTING RUBBER BASE.
- B. REMOVE ALL EXISTING FURNITURE. VERIFY POSSIBLE REUSE WITH FACILITIES.

Date/Signature

Project
Global Learning Conference Center, Bldg #170
Georgia Institute of Technology, Room #317

Project Number
#183-2011 / 11.001.01 (HLG)

File Name
A01-03.DWG

Description
3RD FLOOR DEMOLITION PLAN

Scale
1/8"=1'-0"

Sheet Number
A01.03

KEY NOTES

- ① PROVIDE 3/8" METAL STUD WITH 5/8" GYPSUM WALLBOARD ON ONE SIDE FOR WALL CHASE

Hughes | Litton | Godwin

Design Partnership
 117 Peachtree Street, NE
 Suite 1700
 Atlanta, Georgia 30309
 404.762.7788
 Fax 404.520.7187

This drawing is the property of HUGHES | LITTON | GODWIN and is not to be reproduced or copied in whole or in part. It is only to be used for the project and site specifically identified herein and is not to be used on any other project. All drawings are to be returned to HUGHES | LITTON | GODWIN if requested.

Global Learning Conference Center

Bldg #170, Georgia Institute of Technology, Room #317
 84 8th Street Northwest
 Atlanta, GA 30306

Issue	Date & Description	By
1	05/16/2011 FOR BID	CH

SHED NOTES

ALL EXISTING PARTITIONS TO REMAIN.

Signature

Project

Global Learning Conference Center, Bldg #170 Georgia Institute of Technology, Room #317

Project Number

#185-2011 / 11.001.01 (HLG)

File Name

A02-03.DWG

Description

3RD FLOOR PARTITION PLAN

Scale

1/4"=1'-0"

Sheet Number

A02.03

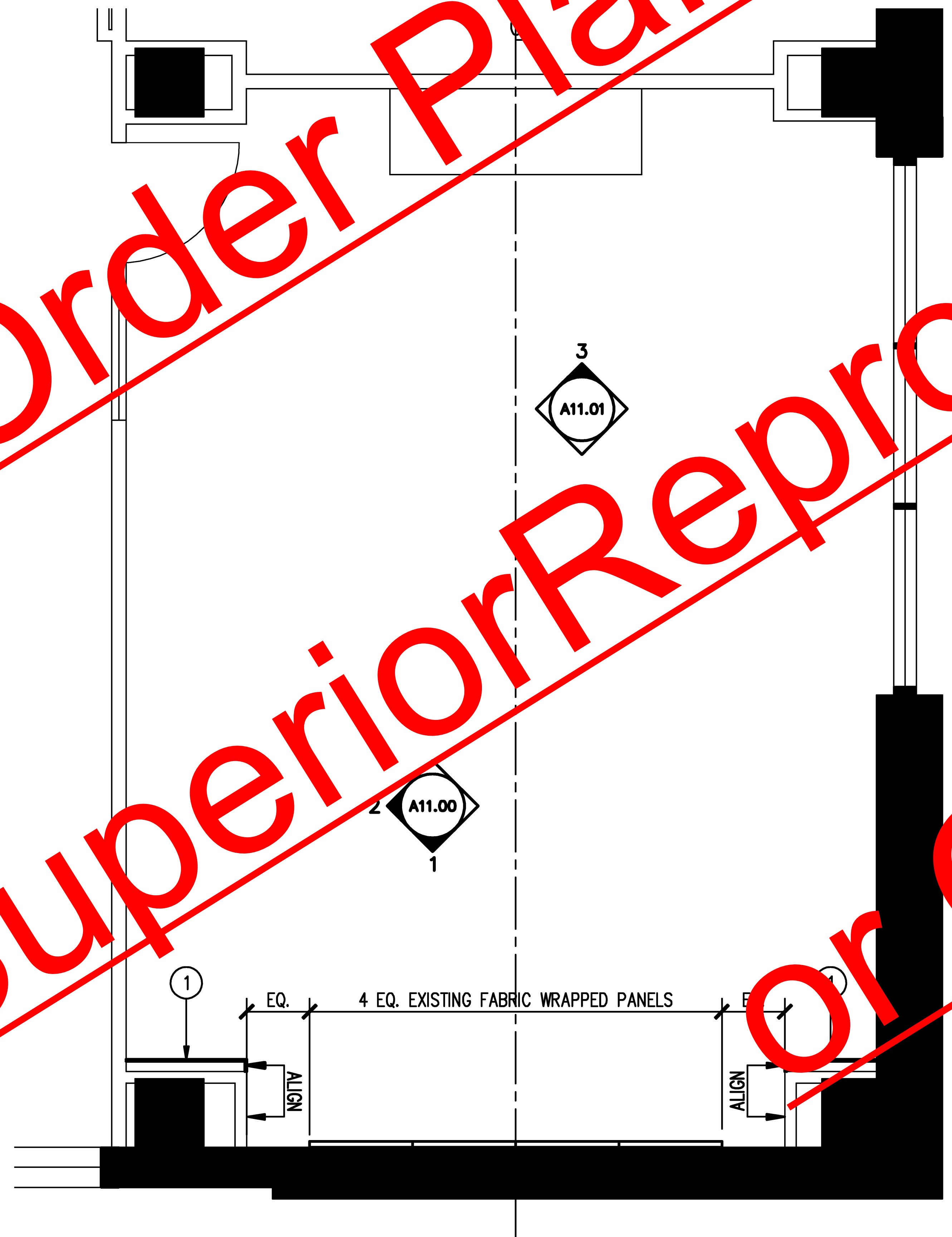

Order Plans @
 www.SuperiorReprographics.com
 Or Call
 770-944-7293

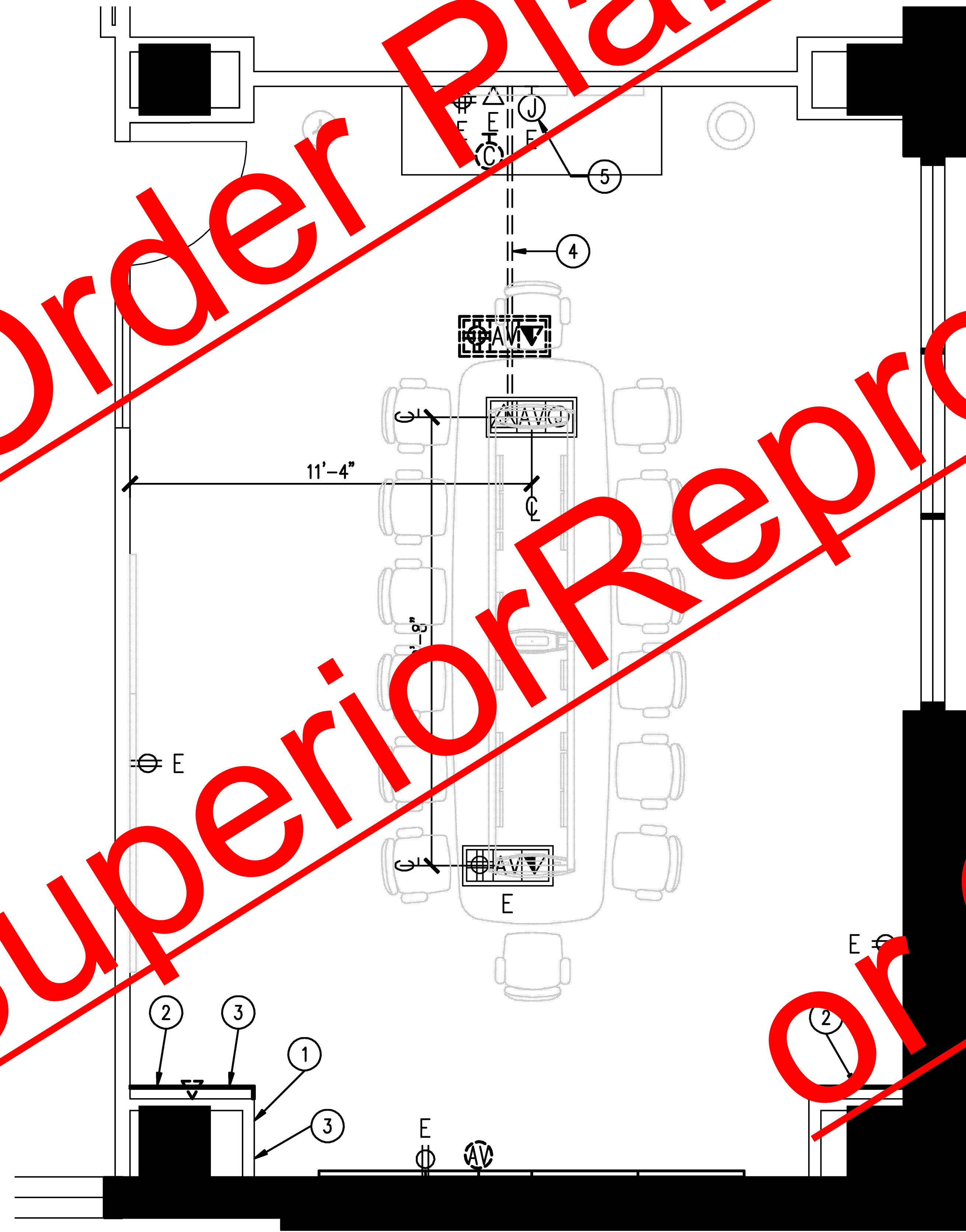

KEY NOTES

- ① REMOVE EXISTING WALL-MOUNTED TELEPHONES AND ALL ASSOCIATED CONDUIT.
- ② REMOVE EXISTING WALL-MOUNTED SPEAKER, MAGNET AND RECEPTANES.
- ③ REMOVE EXISTING TOUCH PANEL AND BEHIND WALL PLATES.
- ④ REUSE EXISTING CONDUIT FOR AV IF POSSIBLE. REFER TO AV CONSULTANT DRAWINGS FOR MORE INFORMATION.
- ⑤ REUSE EXISTING IN WALL CONDUIT, REVISE AS REQUIRED FOR NEW POWER AND DATA.

Hughes | Littton | Godwin
 Design Partnership

117 Peachtree Street, NE
 Suite 317
 Atlanta, Georgia 30309
 404.762.7788
 Fax 404.762.7787

Global Learning Conference Center

Bldg #170, Georgia Institute of Technology, Room #317
 84 8th Street Northwest
 Atlanta, GA 30306

Issue	Date & Description	By
1	05/16/2011 FOR BID	CH

SHIET NOTES

- A. PATCH AND REPAIR WALL AS REQUIRED WHERE EXISTING ITEMS ARE TO BE REMOVED.
- B. REPLACE ALL EXISTING TO REMAIN OUTLET COVERS WITH NEW OR REFURBISHED COVERS.
- C. REFER TO ELETTRICAL ENGINEERING DRAWINGS FOR CIRCUITING AND SPECIFIC REQUIREMENTS.
- D. CONTRACTOR IS RESPONSIBLE FOR SCANNING FLOOR SLAB TO AVOID POST-TENSION CABLING AND EXISTING CONDUIT.

Project
 Global Learning Conference Center, Bldg #170
 Georgia Institute of Technology, Room #317

Project Number
 #185-2011 / 11.001.01 (HLG)

File Name
 A03-03.DWG

Description
 3RD FLOOR POWER & COMMUNICATION PLAN

Scale
 1/4"=1'-0"

Sheet Number
A03.03

Order Plans @
 www.SuperiorReprographics.com
 or Call
 770-944-7293

www.SuperiorReprographics.com
 Order Plans @
 or Call
 770-944-7293

KEY NOTES

- ① RECESSED POCKET FOR BLACK-OUT MECHOSHADE.
- ② RECESSED PROJECTOR SCREEN INSTALLED BY GENERAL CONTRACTOR REFER TO AV SPECIFICATIONS.
- ③ EXISTING COVE LIGHT AND RETURN AIR PLENUM TO REMAIN.
- ④ REMOVE GYPSUM BOARD CEILING. PAINT BUILDING STANDARD CEILING WHITE.
- ⑤ REPLACE EXISTING PERFORATED PLATE DIFFUSERS WITH NEW ALUMINUM LOUVERED FACED 3 CONE TYPE WITH 10" ROUND INLET. DIFFUSER TO BE TITUS TMSA-AA OR EQUAL.
- ⑥ PAINT EXISTING GYP. BOARD CEILING BUILDING STANDARD CEILING WHITE.
- ⑦ NEW LUTRON (OR EQUAL) GRAPHIC EYE FOR LIGHTING AND PROJECTOR SCREEN CONTROL.
- ⑧ POWER AND DATA RECEPTACLES FOR NEW RECESSED PROJECTOR. REFER TO AV DRAWINGS FOR EXACT LOCATION.
- ⑨ NEW 4' X 8' CEILING TILE AND GRID. SEE SHEET A00.10 FOR SPECIFICATION.
- ⑩ POWER RECEPTICAL FOR NEW RECESSED PROJECTOR SCREEN.
- ⑪ NEW CLOCK OUTLET LOCATION. CLOCK TIED TO BUILDING SYSTEM BY FACILITIES.
- ⑫ NEW 2'X2' CEILING TILE AND GRID. SEE SHEET A00.10 FOR SPECIFICATION.
- ⑬ POWER RECEPTICAL FOR NEW MOTORIZED MECHOSHADE.

SHOE NOTES

A. REMOVE ALL EXISTING LIGHT FIXTURES (EXCEPT COVE LIGHTING), CEILING TILE AND GRID, MINI-BLINDS, PROJECTORS, HVAC, PROJECTOR SCREENS, DIFFUSERS AND ELECTRICAL OUTLETS. COORDINATE STORAGE OF THESE ITEMS WITH GEORGIA TECH FACILITIES.

B. EXISTING SPRINKLERS TO REMAIN. RELOCATE TO BE CENTERED ON NEW CEILING GRID.

C. REFER TO ELECTRICAL ENGINEERING DRAWINGS FOR CIRCUITING AND SPECIFIC REQUIREMENTS.

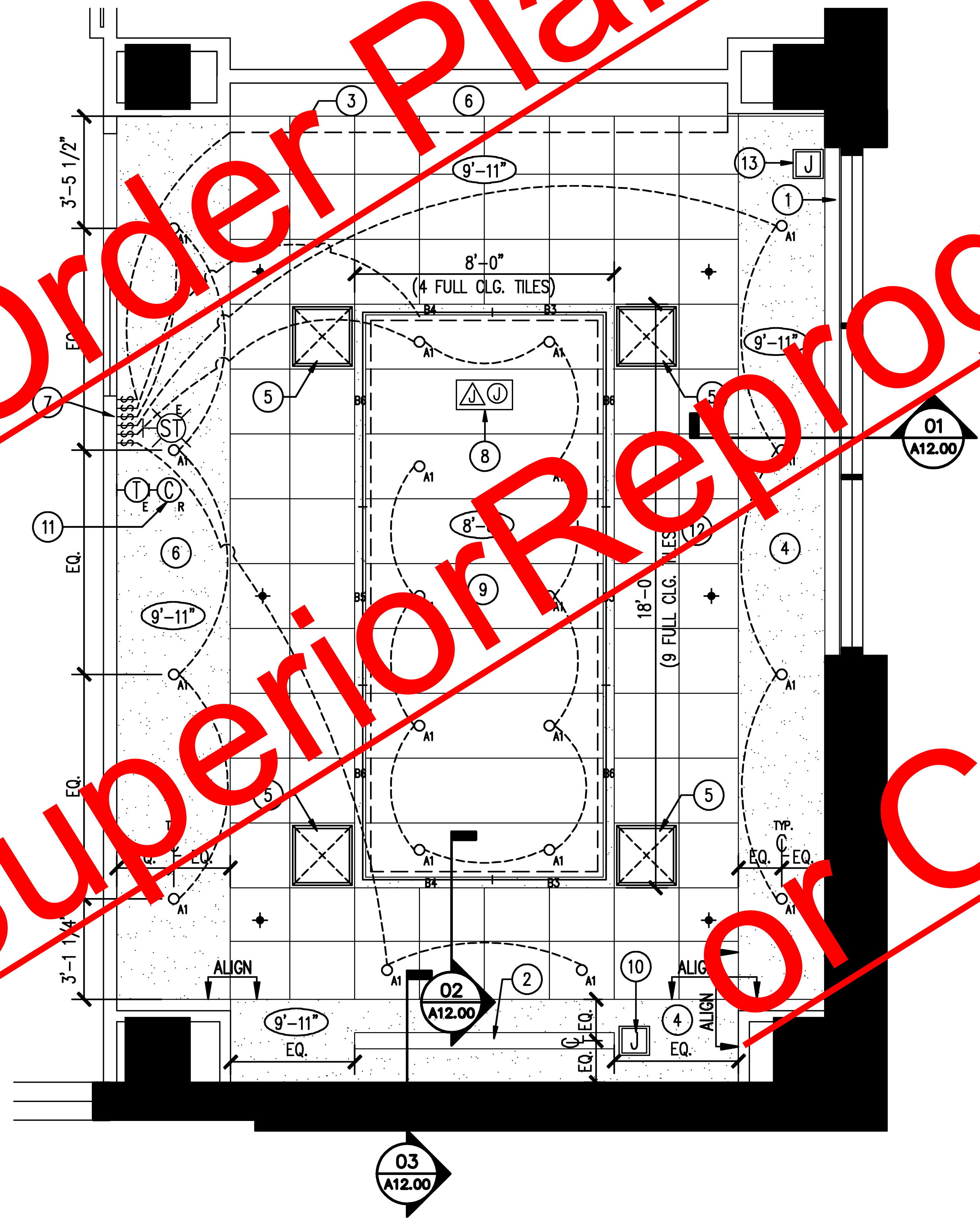

Hughes | Litton | Godwin

Equal Partnership
 117 Peachtree Street, NE
 Suite 500
 Atlanta, Georgia 30309
 404.762.7788
 Fax 404.580.5787

This drawing is the property of HUGHES | LITTON | GODWIN and is not to be reproduced or copied in whole or in part. It is only to be used for the project and site specifically identified herein and is not to be used on any other project. All drawings are to be returned to HUGHES | LITTON | GODWIN if requested.

Global Learning Conference Center
 Bldg #170, Georgia Institute of Technology, Room #317
 84 8th Street Northwest
 Atlanta, GA 30306

Issue	Date & Description	By
1	05/16/2011 FOR BID	CH

Project	Global Learning Conference Center, Bldg #170 Georgia Institute of Technology, Room #317
Project Number	#183-2011 / 11.001.01 (HLG)
File Name	A04-03.DWG
Description	3RD FLOOR REFLECTED CEILING PLAN
Scale	1/4"=1'-0"
Sheet Number	

A04.03

P:\11031001\11001001\001\Sheet\A04-03.dwg May 16, 2011 10:50am sfern



KEY NOTES

- ① PAINT METAL DOOR AND FRAMES ON ROOM SIDE ONLY P-1.
- ② MOTORIZED BLACK-OUT SHADE SYSTEM. MANUF: MECHOSHADE SYSTEMS STYLE: BUCKET WEAVE SHADECLOSE 1550 COLOR: 552 BRN OPENNESS: 3% FASCIA: WHITE CONTRACTOR TO VERIFY DIMENSIONS.
- MOTORIZED URBANSHADE SYSTEM. LOW VOLTAGE MODEL WITH WIRELESS RTS. UNIVERSAL CEILING MOUNT (ROOM-DARKENING SIDE CHANNEL AS REQUIRED.)

FINISH SCHEDULE

PAINT

- P-1 MANUF: SHERWIN WILLIAMS COLOR: WOOL SKEIN COLOR #: SW6148 FINISH: EGGHELL CONTACT: DWIGHT LECLAIR 678.261.6865
- P-2 MANUF: SHERWIN WILLIAMS COLOR: OUTERBANKS COLOR #: SW7534 FINISH: EGGHELL CONTACT: DWIGHT LECLAIR 678.261.6865

BASE

- B-1 MANUF: MANNINGTON PROFILE: EDGE EFFECTS, ICONIC COLOR: 924 TOASTED SESAME TYPE: TP-RUBBER, MITERED CORNERS SIZE: 4 1/4" HIGH CONTACT: LAURA ANN BAKER 404.308.2142

CARPET

- C-1 MANUF: INVISON STYLE: SHANTUNG STYLE #: 9160 COLOR: TEAK COLOR #: 904 PATTERN: 24" X 24" FIBER: 100% SOLUTIA ULTRON COLOR: NYLON CONTACT: ALLAN MARTIN 678.229.0131

FABRIC WRAPPED PANELS

- FP-1 MANUF: POLY-TEXTILES NAME: GUILD STYLE #: W4441/4 WIDTH: 54" CONTACT: SANDI MARTIN 404.229.0597

STONE

- ST-1 MANUF: ZODIAQ COLOR: MINERA PEARL FINISH: POLISHED THICKNESS: 3 CM CONTACT: MARTHA R. SMITH 678.699.0027

Hughes | Litton | Godwin

Design Partnership
 117 Peachtree Street, NE
 Suite 1500
 Atlanta, Georgia 30309
 404.761.7788
 Fax 404.761.7187

This drawing is the property of HUGHES | LITTON | GODWIN and is not to be reproduced or copied in whole or in part. It is only to be used for the project and site specifically identified herein and is not to be used on any other project. All drawings are to be returned to HUGHES | LITTON | GODWIN if requested.

Global Learning Conference Center
 Bldg #170, Georgia Institute of Technology, Room #317
 84 8th Street Northwest
 Atlanta, GA 30306

Issue	Date & Description	By
1	05/16/2011 FOR BID	CH

 Designer

 Checker

Project
 Global Learning Conference Center, Bldg #170
 Georgia Institute of Technology, Room #317

Project Number
 #183-2011 / 11.001.01 (HLG)

File Name
 A05-03.DWG

Description
 3RD FLOOR FINISH PLAN

Scale
 1/4"=1'-0"

Sheet Number

A05.03

P:\100000\100000\100000\Shades\A05-03.dwg May 16, 2011 10:51am ahlrns

KEY NOTES

Hughes | Litton | Godwin
 Design Partnership

117 Peachtree Street, NE
 Suite 300
 Atlanta, Georgia 30309
 404.762.7788
 Fax 404.762.7787

This drawing is the property of HUGHES | LITTON | GODWIN and is not to be reproduced or copied in whole or in part. It is only to be used for the project and site specifically identified herein and is not to be used on any other project. All drawings are to be returned to HUGHES | LITTON | GODWIN if requested.

Global Learning Conference Center

Bldg #170, Georgia Institute of Technology, Room #317
 84 8th Street Northwest
 Atlanta, GA 30306

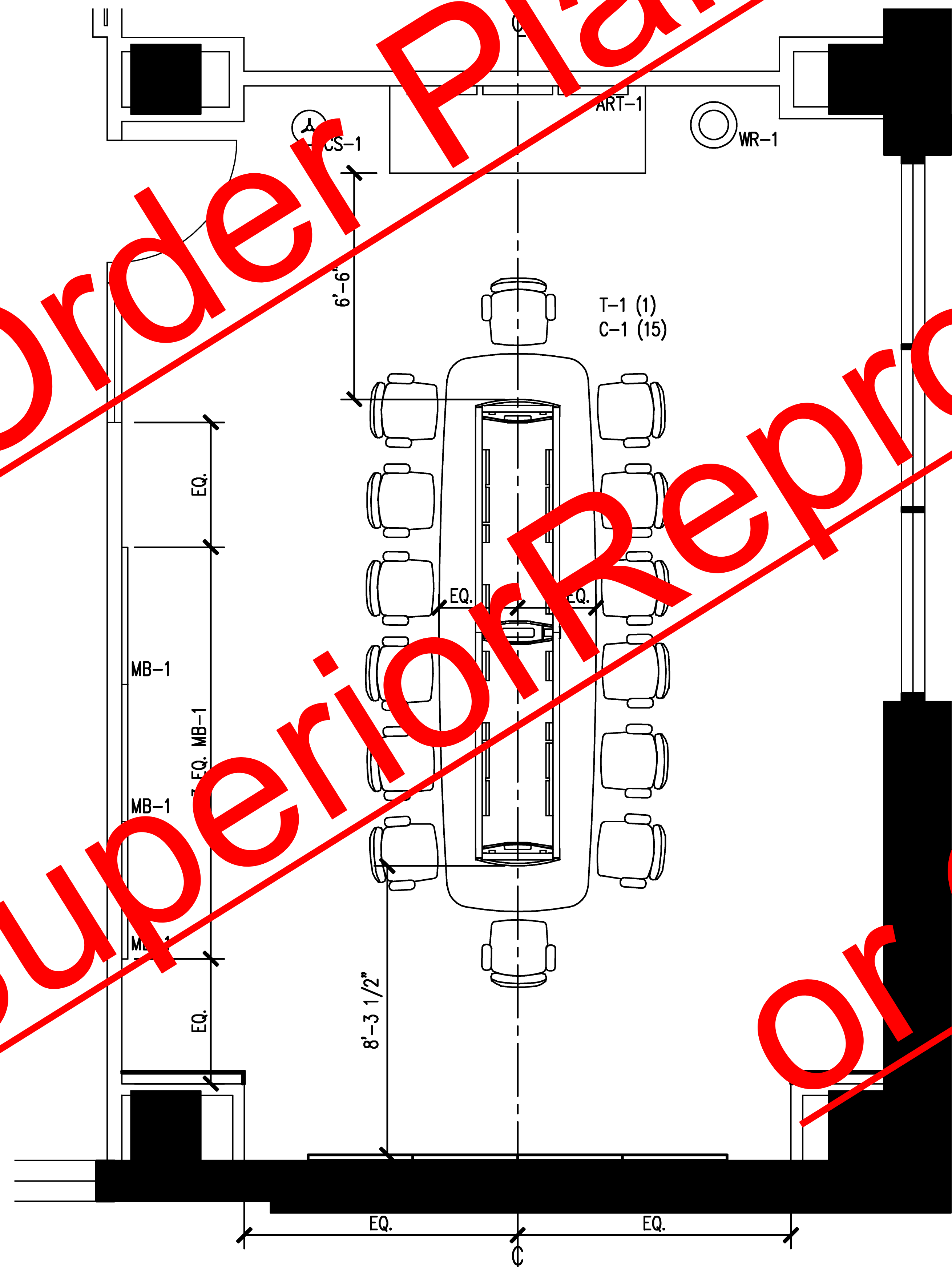

SHEET NOTES

A. REFER TO FURNITURE SPECIFICATION FOR MORE INFORMATION.

B. REMOVE ALL EXISTING FURNITURE AND ACCESSORIES. COORDINATE STORAGE OR RE-LOCATION WITH GEORGIA TECH FACILITIES.

C. TABLE AND CRENZA TO BE CENTERED ON CENTER LINE OF SOUTH WALL NICHE.

Issue	Date & Description	By
1	05/16/2011 FOR BID	CH

 Designer

Project
 Global Learning Conference Center, Bldg #170
 Georgia Institute of Technology, Room #317

Project Number
 #183-2011 / 11.001.01 (HLG)

File Name
 A06-03.DWG

Description
 3RD FLOOR FURNITURE PLAN

Scale
 1/4"=1'-0"

A06.03

P:\11001\01\11001\01\03\Drawings\A06-03.dwg May 16, 2011 10:25am shern

770-944-7293

KEY NOTES

- ① NEW MAGNETIC GLASS MARKER BOARD, MB-1
- ② EXISTING THERMOSTAT
- ③ NEW FRAMELESS SIGN PLAN PROVIDED BY FACILITIES
- ④ EXISTING LIFE STROKE
- ⑤ NEW CLOCK PROVIDED BY FACILITIES
- ⑥ LIGHTING/AV CONTROL PANEL
- ⑦ TRIM PANELS TO 78"H AND REUPHOLSTERED FABRIC WRAPPED PANELS, FP-1

Hughes | Litton | Godwin
 Design Partnership
 117 Peachtree Street, NE
 Suite 1700
 Atlanta, Georgia 30309
 404.763.7788
 Fax 404.600.7787

This drawing is the property of HUGHES | LITTON | GODWIN and is not to be reproduced or copied in whole or in part. It is only to be used for the project and site specifically identified herein and is not to be used on any other project. All drawings are to be returned to HUGHES | LITTON | GODWIN if requested.

Global Learning Conference Center
 Bldg #170, Georgia Institute of Technology, Room #317
 84 8th Street Northwest
 Atlanta, GA 30306

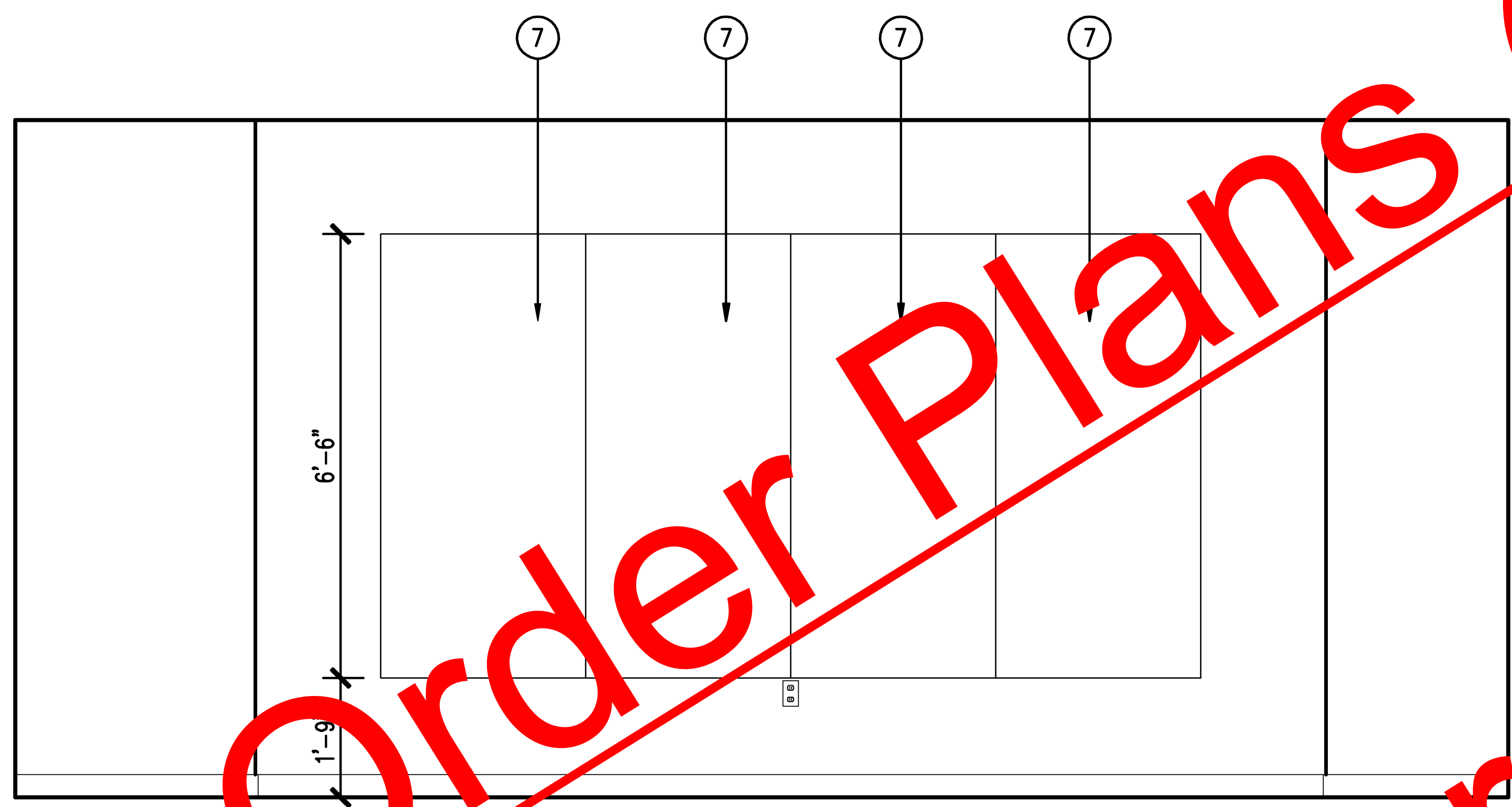

01 ELEV. @ FABRIC WRAPPED PANELS

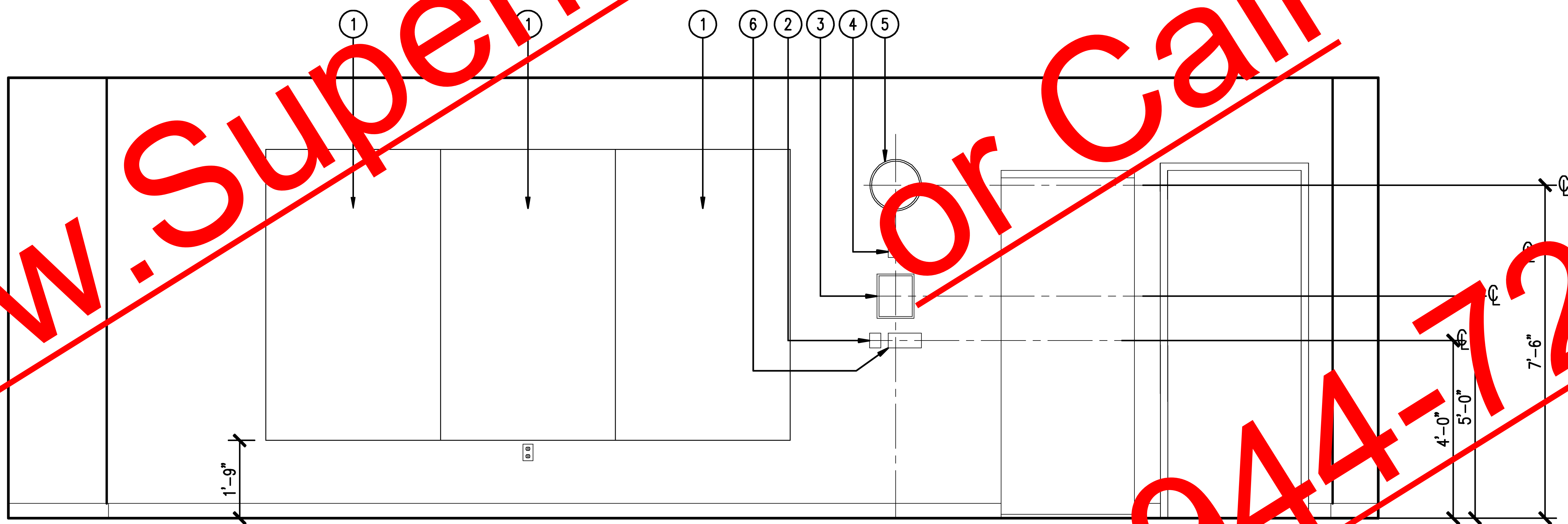

SHEET NOTES

Issue	Date & Description	By
1	05/16/2011 FOR BID	CH

 Designer/Author

Project:
 Global Learning Conference Center, Bldg #170
 Georgia Institute of Technology, Room #317

Project Number:
 #183-2011 / 11.001.01 (HLG)

File Name:
 A11-00.DWG

Description:
 ELEVATIONS

Scale:
 1/4"=1'-0"

Sheet Number:
A11.00

02 ELEV. @ MARKER BOARD WALL

www.SuperiorReprographics.com

Or Call 770-944-7293

www.SuperiorReprographics.com
 or Call
 770-944-7293

KEY NOTES

- ① GEORGIA TECH GLOBAL LEARNING CENTER ARTWORK PROVIDED BY GRAPHICS DEPARTMENT
- ② LOCKABLE CABINET FOR AV EQUIPMENT
- ③ CABINET FOR USER EQUIPMENT RACK - NO LOCK
- ④ CABINET FOR USER SUPPLIES - NO LOCK

Hughes | Litton | Godwin
 Design Partnership

117 Peachtree Street, NE
 Suite 1100
 Atlanta, Georgia 30309
 404.762.7788
 Fax 404.560.7187

This drawing is the property of HUGHES | LITTON | GODWIN and is not to be reproduced or copied in whole or in part. It is only to be used for the project and site specifically identified herein and is not to be used on any other project. All drawings are to be returned to HUGHES | LITTON | GODWIN if requested.

**Global Learning
 Conference Center**
 Bldg #170, Georgia Institute of
 Technology, Room #317
 84 8th Street Northwest
 Atlanta, GA 30306

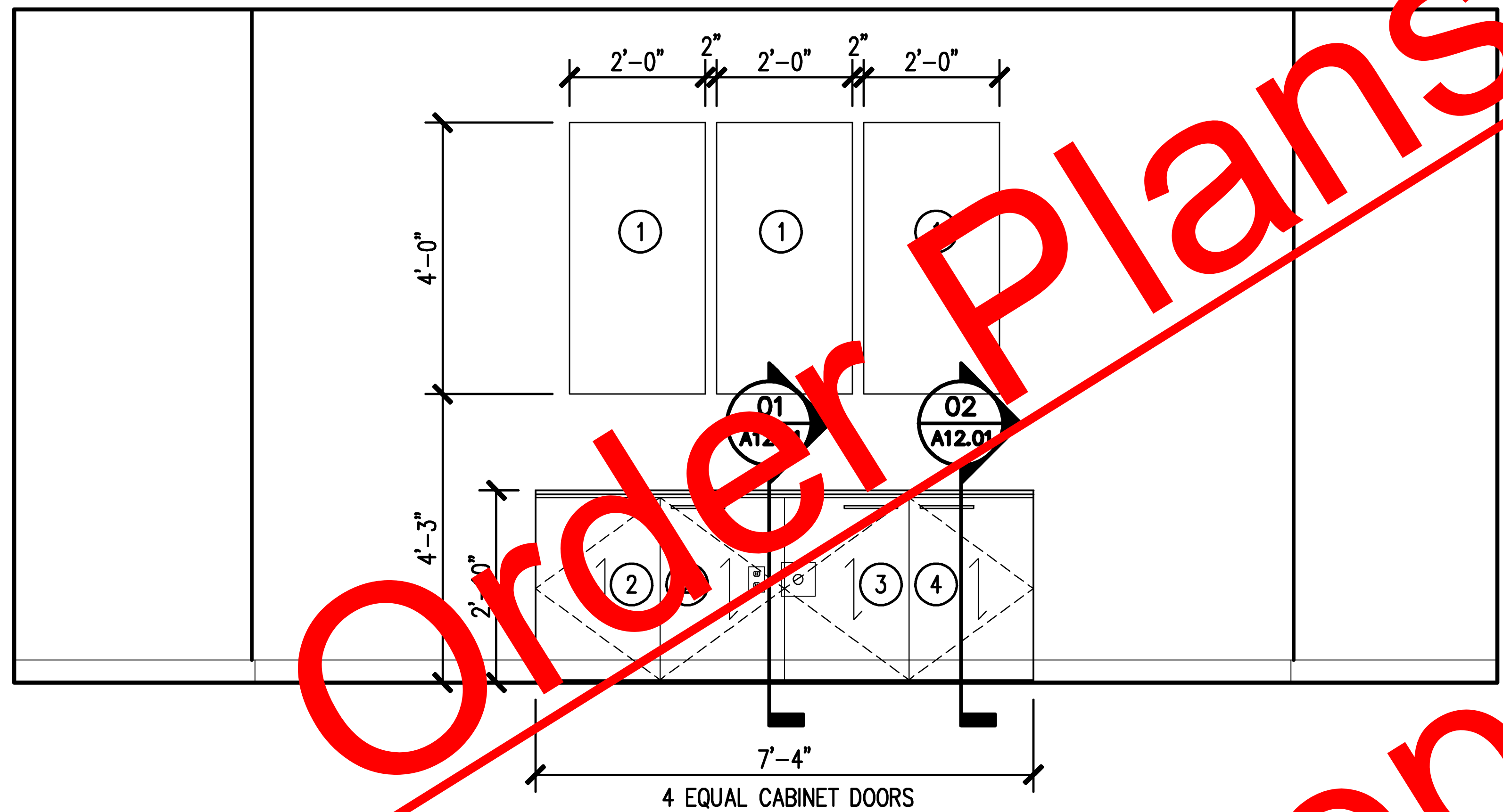

03 | ELEV. @ CREDENZA AND ARTWORK

Issue	Date & Description	By
1	05/16/2011 FOR BID	CH

SHEET NOTES

 Signature

Project
 Global Learning Conference Center, Bldg #170
 Georgia Institute of Technology, Room #317

Project Number
 #185-2011 / 11.001.01 (HLG)

File Name
 A11-01.DWG

Description
 ELEVATIONS

Scale
 1/4" = 1'-0"

Sheet Number

A11.01

P:\11001\01\11001_01\Sheet\A11-01.dwg May 16, 2011 10:55am atms

KEY NOTES

Hughes | Litton | Godwin
 Design Partnership

117 Peachtree Street, NE
 Suite 1700
 Atlanta, Georgia 30309
 404.762.7788
 Fax 404.600.7187

This drawing is the property of HUGHES | LITTON | GODWIN and is not to be reproduced or copied in whole or in part. It is only to be used for the project and site specifically identified herein and is not to be used on any other project. All drawings are to be returned to HUGHES | LITTON | GODWIN if requested.

Global Learning Conference Center

Bldg #170, Georgia Institute of Technology, Room #317
 84 8th Street Northwest
 Atlanta, GA 30306

Issue	Date & Description	By
1	05/16/2011 FOR BID	CH

SHEET NOTES

 Signature

Project
 Global Learning Conference Center, Bldg #170
 Georgia Institute of Technology, Room #317

Project Number
 #183-2011 / 11.001.01 (HLG)

File Name
 A12-00.DWG

Description
 CEILING DETAILS

Scale
 AS NOTED

Sheet Number

A12.00

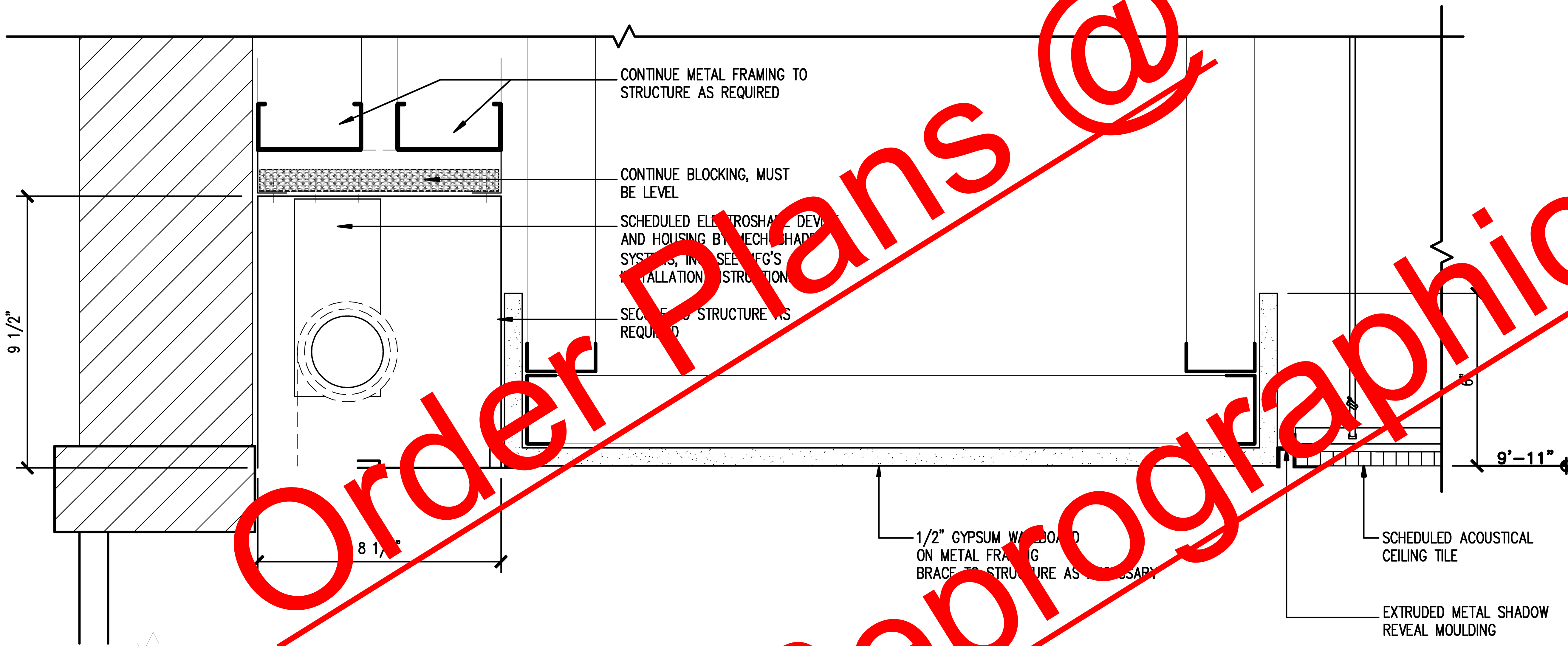

01 DETAIL @ BLACK-OUT SHADE
 SCALE: 3" = 1'-0"

CLG_01.DWG

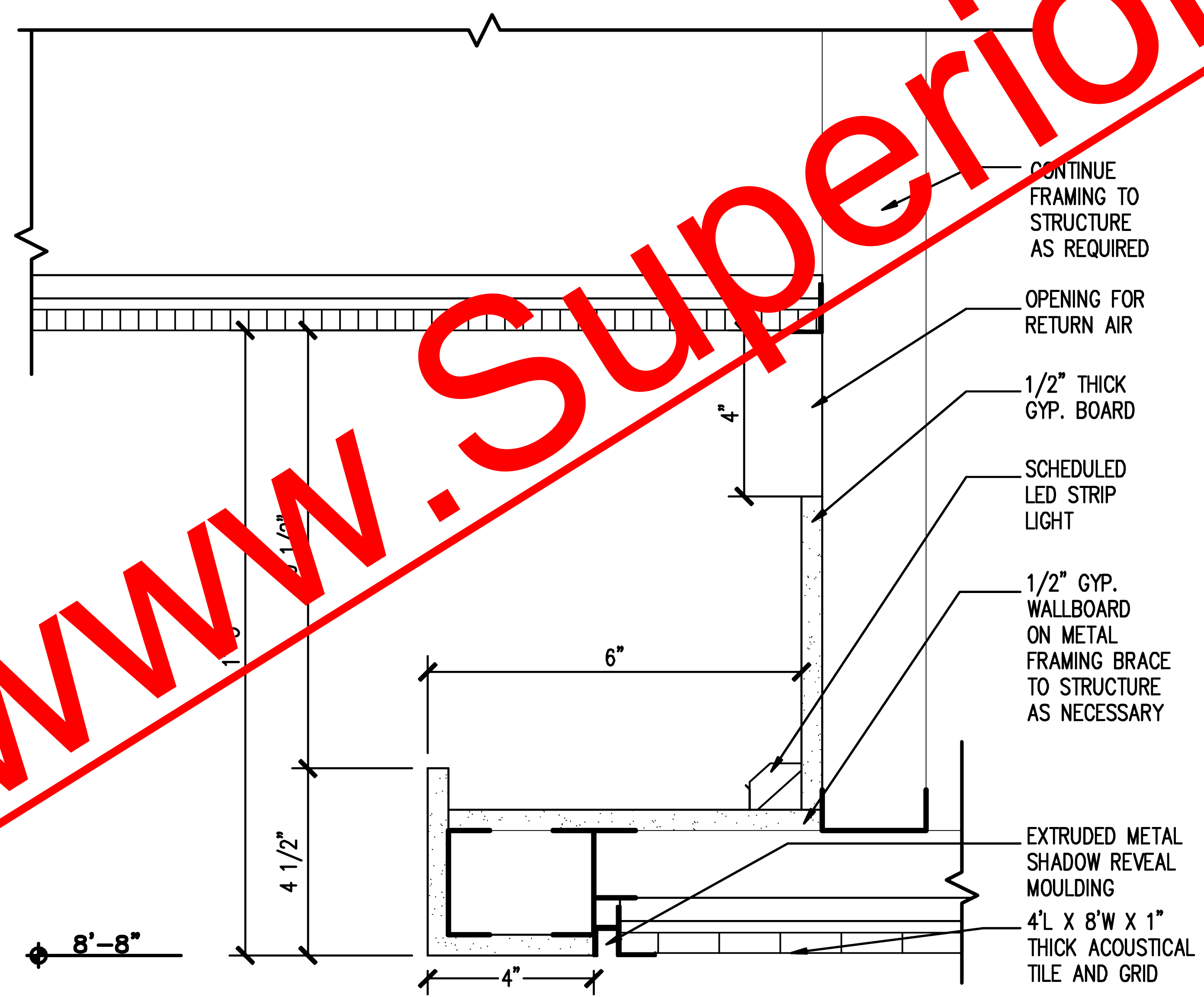

02 DETAIL @ COVE LIGHTING
 SCALE: 3" = 1'-0"

CLG_02.DWG

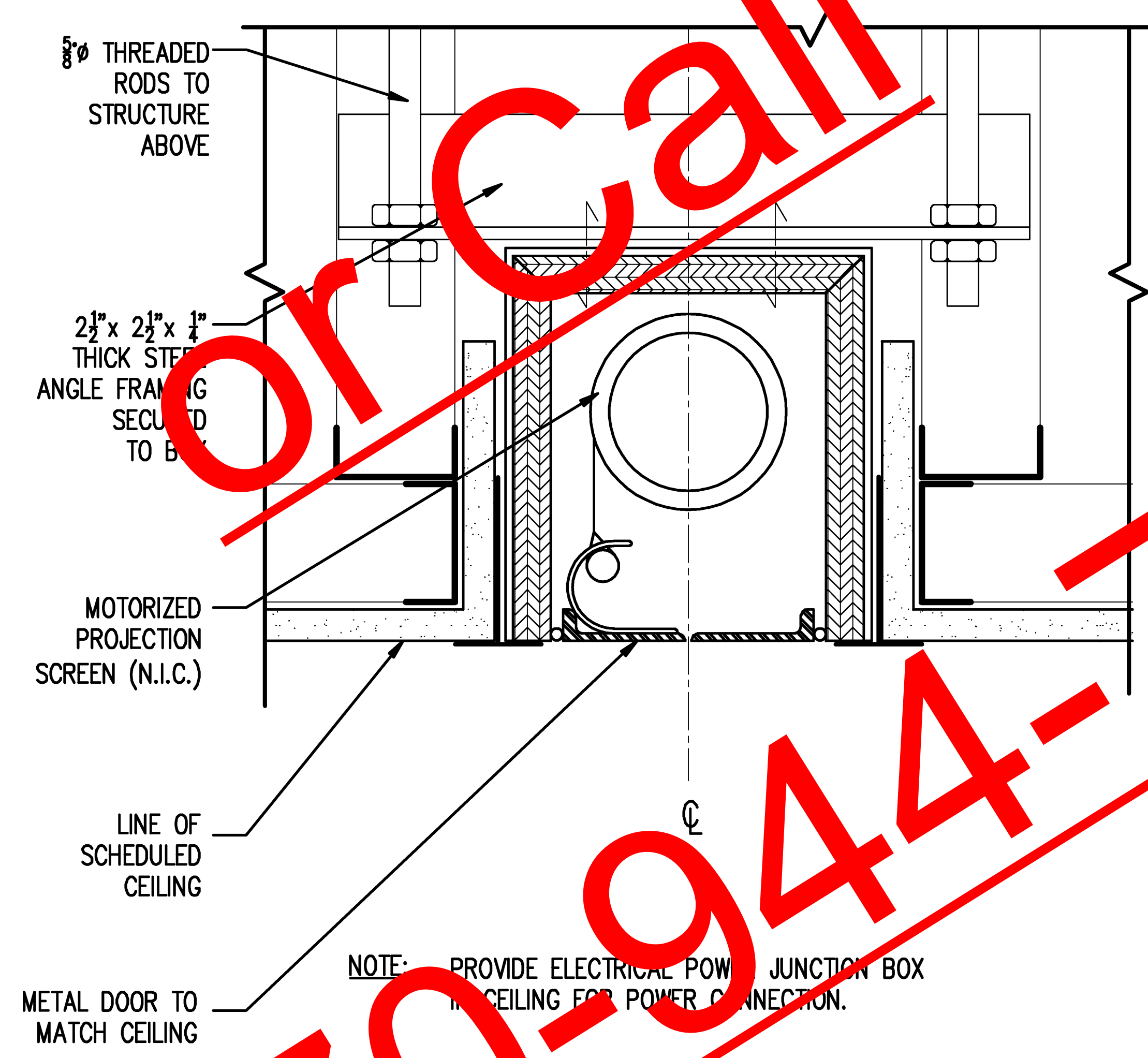

03 DETAIL @ PROJECTION SCREEN
 SCALE: 3" = 1'-0"

CLG_03.DWG

www.SuperiorReprographics.com
 or Call 770-944-7293

KEY NOTES

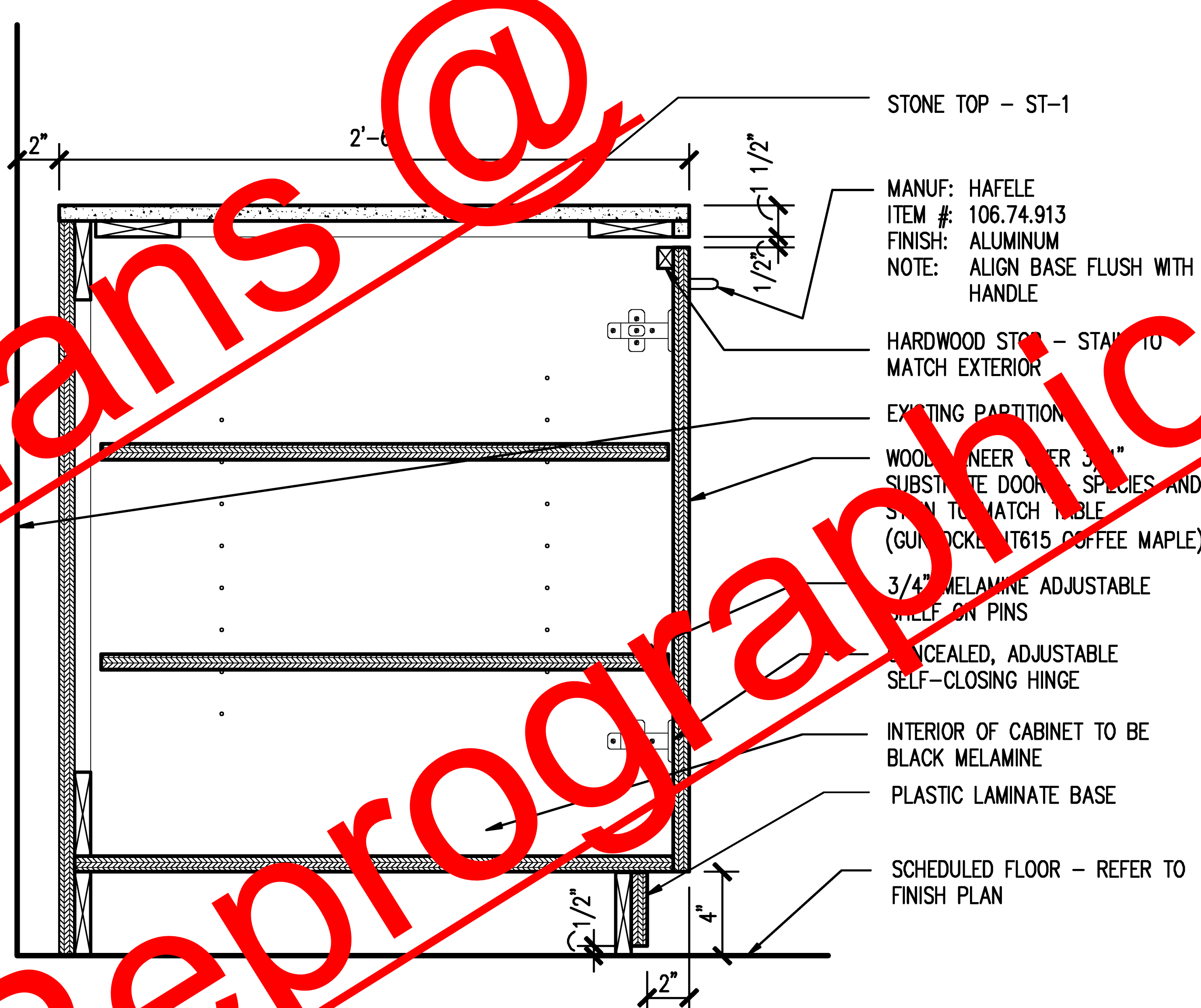
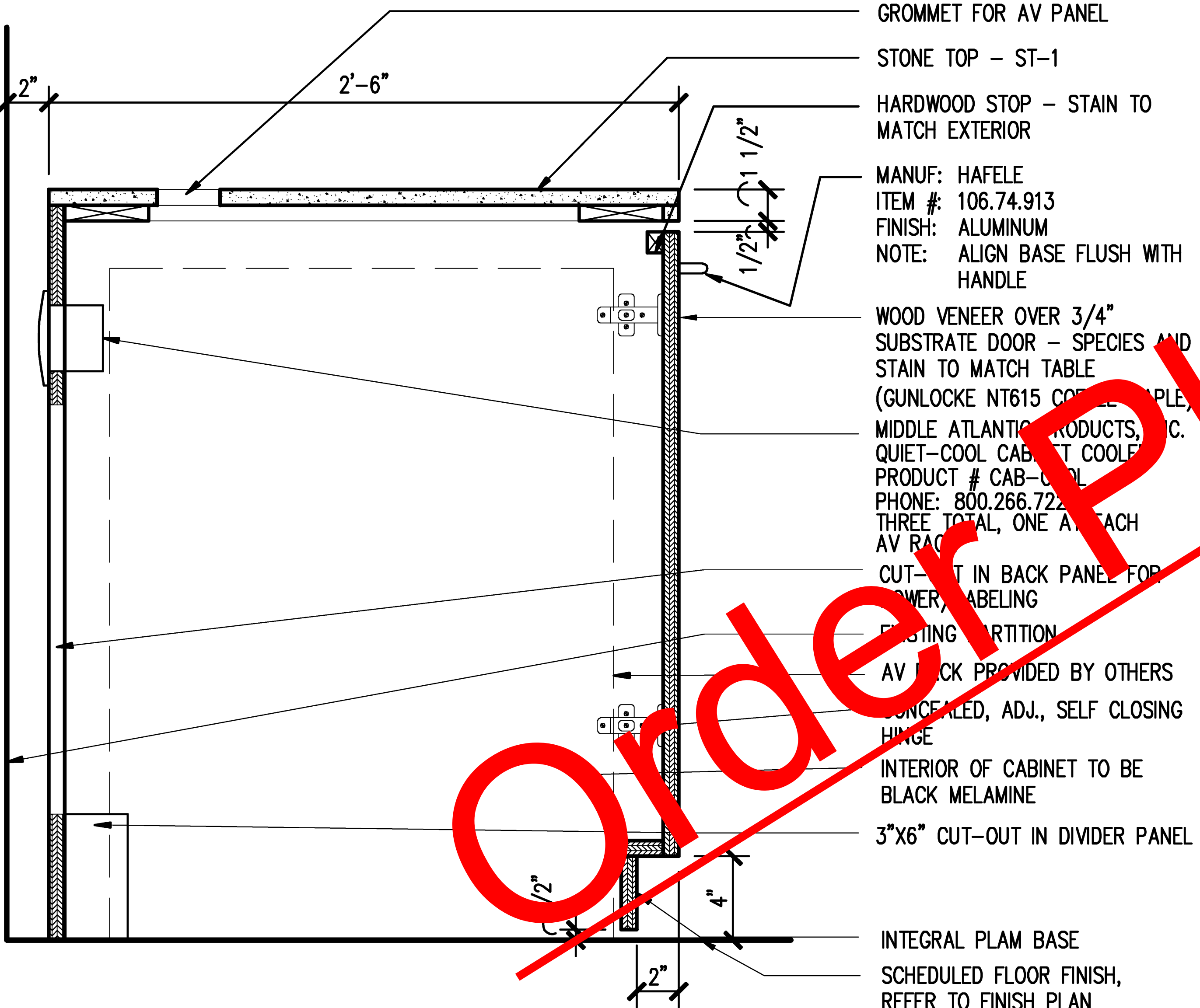

01 SECTION @ AV CREDENZA
SCALE: 1 1/2" = 1'-0"

MW_11.dwg

02 SECTION @ AV CRADENZA
SCALE: 1 1/2" = 1'-0"

MW_12.DWG

Issue	Date & Description	By
1	05/16/2011 FOR BID	CH

SHEET NOTES

Project
Global Learning Conference Center, Bldg #170
Georgia Institute of Technology, Room #317

Project Number
#183-2011 / 11.001.01 (HLG)

File Name
A12-01.DWG

Description
MILLWORK DETAILS

Scale
AS NOTED

Sheet Number

A12.01

WWW.SuperiorReprographics.com
or Call
770-944-7293

Order Plans @



GENERAL NOTES

- EXISTING LIGHTING FIXTURES WHICH ARE NOT SHOWN TO BE REMOVED SHALL REMAIN.
- EXISTING JUNCTION BOXES ABOVE THE NEW DRYWALL FINISHES SHALL BE RELOCATED TO AREAS ABOVE LAYIN TILES. SEE ARCHITECTURAL SHEETS FOR CEILING PLAN.
- SEE KEY SHEETS FOR ADDITIONAL RECEPTACLE INSTALLATION.
- SEE KEY SHEETS FOR FLOOR BOX DIMENSIONS AND LOCATIONS.

KEY NOTES

- EXISTING FLOOR BOX TO BE ABANDONED. REMOVE EXISTING DEVICES, CABLING, AND RECEPTACLE CIRCUIT. CIRCUIT TO BE REUSED FOR NEW POKETHRU RECEPTACLES
- EXISTING FLOOR BOX TO REMAIN
- EXISTING PROJECTOR RECEPTACLE TO BE REMOVED. CIRCUIT TO BE RECONNECTED FOR NEW PROJECTOR AND PROJECTOR LIFT, SEE KEY NOTE 7.
- EXISTING PROJECTOR RECEPTACLE TO BE REMOVED. CIRCUIT TO BE TERMINATED IN J-BOX ABOVE ACCESSIBLE CEILING.
- EXISTING CIRCUIT FOR PROJECTION SCREENS TO BE DISCONNECTED AND RECONNECTED TO NEW PROJECTION SCREEN. IF CIRCUIT IS ABANDONED, TERMINATE IN J-BOX ABOVE ACCESSIBLE CEILING.
- EXISTING RECEPTACLE TO BE REMOVED, AND REINSTALLED ON NEW CHASE WALL, SEE KEY NOTE 10
- CORE FLOOR AND INSTALL NEW POKE THRU, WIREMOLD BATHPK, OR EQUAL W/(1)BTRAC, (1)BDEC, AND (1)BACTRA DEVICE PLATE, SEE ARCHITECTURAL SHEETS FOR EXACT LOCATION. CONNECT RECEPTACLES TO ABANDONED FLOOR BOX CIRCUIT
- CONNECT CIRCUIT TO NEW PROJECTOR LIFT, SEE AV DRAWINGS FOR LOCATION
- POWER CABLE FOR COVE LIGHTING ELECTRIX LFC-101-32
- REINSTALL RECEPTACLE

LIGHTING FIXTURE SCHEDULE

TYPE	DESCRIPTION	MOUNTING	VOLTAGE	LAMPS	COMMENTS
A1	4" LED DOWNLIGHT, MAXILUME H4-LED 30K W/L1402 CLEAR REFLECTOR AND WHITE TRIM RING, OR EQUAL	RECESSED	277	11W LED	
B3	LED COVE LIGHT, 3' LENGTH - ELECTRIX ILLUMINATION L101 LUMILINE, OR APPROVED EQUAL	SURFACE	277	LED	a, b
B4	LED COVE LIGHT, 4' LENGTH - ELECTRIX ILLUMINATION L101 LUMILINE, OR APPROVED EQUAL	SURFACE	277	LED	a
B5	LED COVE LIGHT, 5' LENGTH - ELECTRIX ILLUMINATION L101 LUMILINE, OR APPROVED EQUAL	SURFACE	277	LED	a
B6	LED COVE LIGHT, 6' LENGTH - ELECTRIX ILLUMINATION L101 LUMILINE, OR APPROVED EQUAL	SURFACE	277	LED	a
E	EXISTING SWITCHED FLUORESCENT FIXTURES TO REMAIN	SURFACE	277	T8	

COMMENTS:

- SUPPLY JUMPER CABLES TO CONNECT LED FIXTURE SEGMENTS, ELECTRIX JC-L101-ST, OR JC-L101-FL, AS REQUIRED
- SUPPLY (2) LED POWER SUPPLIES - ELECTRIX PS960

LIGHTING CONTROL SCHEDULE

ZONE	DESCRIPTION	CONTROL METHOD	VOLTAGE	TOTAL LOAD
a	(2) 11W LED DOWNLIGHTS	LINE VOLTAGE DIMMING	277	22W
b	(10) 11W LED DOWNLIGHTS	LINE VOLTAGE DIMMING	277	110W
c	(4) 11W LED DOWNLIGHTS	LINE VOLTAGE DIMMING	277	44W
d	(4) 11W LED DOWNLIGHTS	LINE VOLTAGE DIMMING	277	44W
e	LED COVE LIGHTS	0-10V DIMMING	277	106W
f	SWITCHED FLUORESCENT	SWITCHED	277	192W

COMMENTS: LIGHTING CONTROL SYSTEM BASIS OF DESIGN IS A LUTRON QJQR-6P-11WH. SUPPLY 0-10V POWER MODULE AND SWITCHING MODULE WHERE REQUIRED. ALSO FURNISH RS232 INTERFACE MODULE

GEORGIA INSTITUTE OF TECHNOLOGY
OFFICE OF FACILITIES
DESIGN AND CONSTRUCTION
 955 FOWLER ST., N.W., ATLANTA, GA. 30332-0410
 TELEPHONE: (404) 894-7405

REVISIONS

NO.	DATE	DESCRIPTION

ASBESTOS HAZARD NOTIFICATION
 THE OWNER IS RESPONSIBLE FOR THE REMOVAL OF ASBESTOS THAT MAY EXIST IN MATERIALS THAT CONTAIN ASBESTOS. SEE SPECIAL CONDITIONS OF THE CONTRACT FOR REQUIREMENTS REGARDING ASBESTOS.

PROJECT TITLE
#170 GLOBAL LEARNING CONF. CENTER
CONFERENCE ROOM 317

DESIGN
 BGC 5/16/11

DRAWN
 BGC APPROVED
 DRC

CAD FILE NAME
 11183E01.DWG

SHEET TITLE
 ROOM 317
 DEMO, POWER
 AND LIGHTING

DESIGN/ESTIMATE NO.
 11183

SHEET NO.:
E-1

OF 1

www.SuperiorReprographics.com

770-944-7293

ISSUED FOR BID
 NOT ISSUED FOR CONSTRUCTION

www.SuperiorReprographics.com



www.SuperiorReprographics.com

770-944-7293

ISSUED FOR BID					
SHEET NO. <div style="font-size: 24pt; font-weight: bold; text-align: center;">T-1</div>	OF 1				
DESIGN/ESTIMATE NO. NS4934					
SHEET TITLE ROOM 317 TELECOM PLAN					
CAD FILE NAME NS4934T01.DWG					
DRAWN BY GRH	APPROVED GRH				
DESIGN DATE 05/16/11					
PROJECT TITLE Global Learning Conference Center, Bldg # 170 Georgia Institute of Technology Room 317 - #183-2011					
ASBESTOS HAZARD NOTIFICATION <small>THE OWNER IS RESPONSIBLE FOR THE REMOVAL OF ASBESTOS FROM ANY MATERIALS THAT CONTAIN ASBESTOS. SEE ANY DOCUMENTS FOR REQUIREMENTS REGARDING ASBESTOS.</small>					
REVISIONS <table style="width: 100%; border-collapse: collapse;"> <thead> <tr> <th style="width: 10%;">DATE</th> <th style="width: 90%;">DRAWN BY</th> </tr> </thead> <tbody> <tr> <td> </td> <td> </td> </tr> </tbody> </table>		DATE	DRAWN BY		
DATE	DRAWN BY				
GEORGIA INSTITUTE OF TECHNOLOGY OFFICE OF INFORMATION TECHNOLOGY INFRASTRUCTURE ENGINEERING GROUP <small>Rich Computer Building Atlanta, Georgia 30332-0730</small>					

Order Plans @

www.SuperiorReprographics.com

or Call 770-944-7293

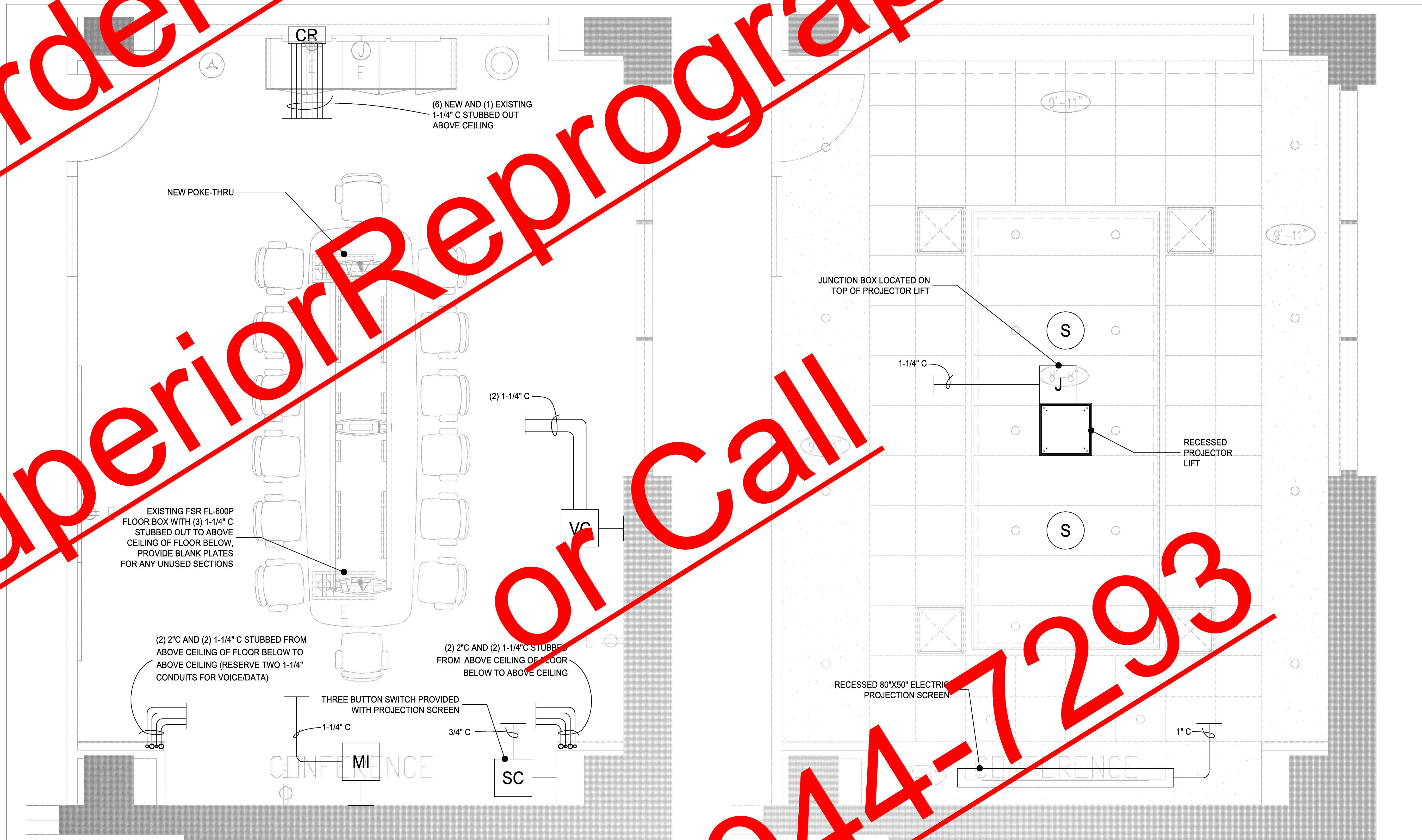

muse
Audio Video
Audiovisual and Acoustical
Consulting and Design Services
2550 Sandy Plains Road
Suite 225, #304
Marietta, Georgia 30066
Voice: 678-921-0567 Fax: 678-921-0581
www.museav.com

© COPYRIGHT 2011, muse, inc.
UNAUTHORIZED USE OR
REPRODUCTION IS PROHIBITED.

GLOBAL LEARNING CONFERENCE CENTER
BUILDING #170
GEORGIA INSTITUTE OF TECHNOLOGY
EXECUTIVE CONFERENCE ROOM 317
PROJECT #183-2011

Georgia Tech.
Global Learning Center
A PROFESSIONAL MEETING AND LEARNING FACILITY

REVISIONS:

NO	DATE	DESCRIPTION
1		

DATE: 16 MAY 2011
FOR BID

SHEET TITLE:
**AV
INFRA-
STRUCTURE
PLAN & RCP**

SHEET:
EAV1.1

AUDIOVISUAL SYSTEMS INFRASTRUCTURE SYMBOL LIST

SYMBOL	FUNCTIONAL DESCRIPTION	INFRASTRUCTURE DESCRIPTION	MOUNTING HEIGHT	RELATED POWER	RELATED IT	COMMENTS
CR	CONFERENCE ROOM RACK BOX	18" WIDE, 12" HIGH, 4" DEEP SCREW COVER BOX	24" A.F.F.	(2) 20A, IG CIRCUITS TERMINATED IN DUPLEXES DIRECTLY ADJACENT	1 DATA PORT, 1 POTS LINE, 5 AMX NETWORK, 1 VIDEO NETWORK	COORDINATE WITH MILLWORK
VC	VIDEOCONFERENCE WALL PLATE	MINIMUM 2-1/2" DEEP 3 GANG BOX	18" A.F.F.	20A, IG CIRCUIT DUPLEX DIRECTLY ADJACENT	DATA PORT FOR IP CONFERENCING	
MI	MEDIA INPUT WALL PLATE	MINIMUM 2-1/2" DEEP 3 GANG BOX	18" A.F.F.	20A, IG CIRCUIT DUPLEX ADJACENT	DATA PORT ADJACENT	
S	CEILING SPEAKER	CONTROL 47C/T SPEAKER	IN CEILING			

NOTES:
1. COORDINATE EXACT LOCATION OF ALL DEVICES WITH INTERIOR DESIGNER AND OWNER
2. PROVIDE BLANK PLATES AS REQUIRED.

SCALE: 1/2" = 1'-0"

Order Plans @

www.SuperiorReprographics.com or Call

770-944-7293

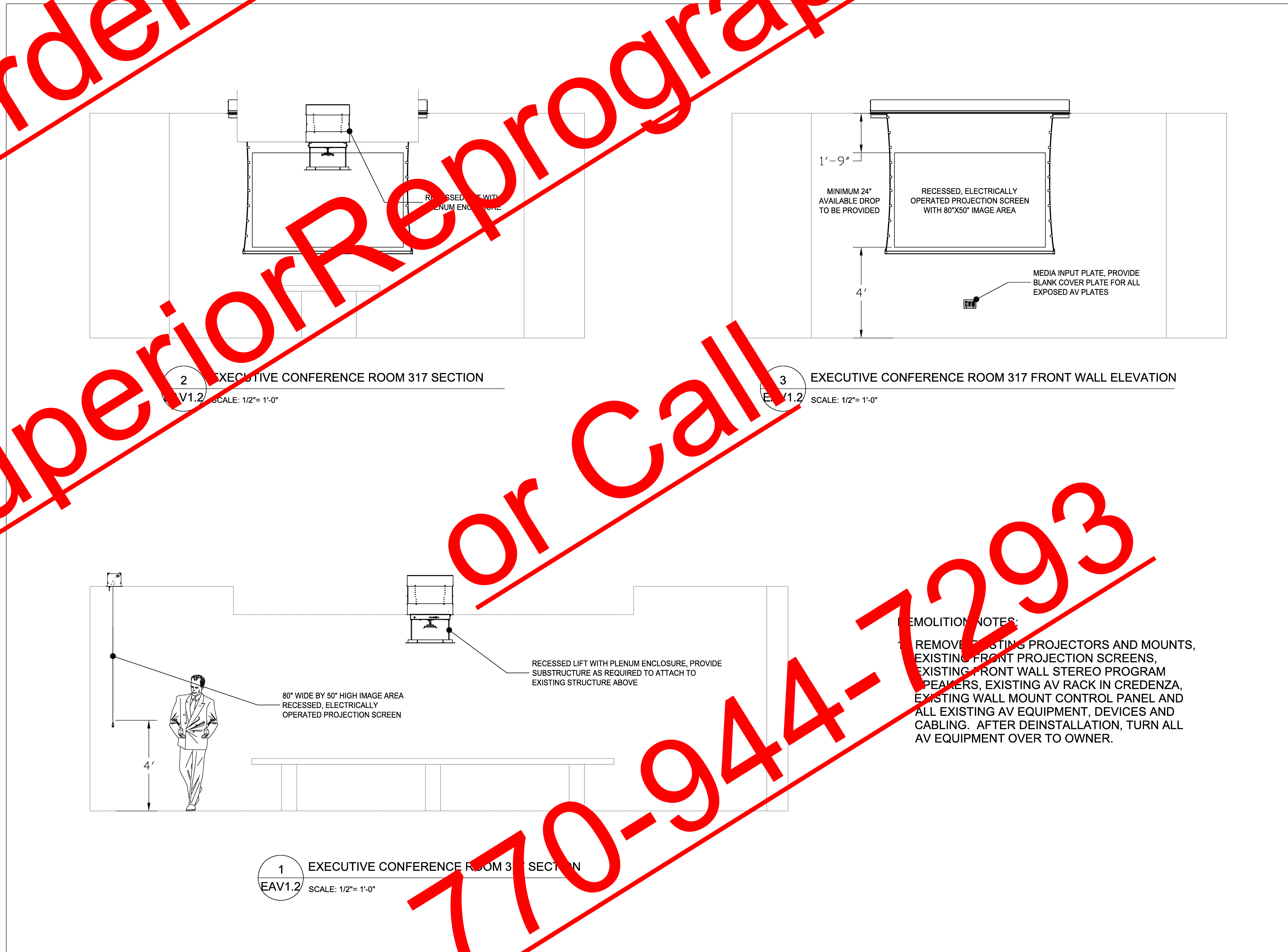

muse
Audio Video

Audiovisual and Acoustical Consulting and Design Services

2550 Sandy Plains Road
Suite 225, #304
Marietta, Georgia 30066

Voice: 678-921-0567 Fax: 678-921-0581
www.museav.com

© COPYRIGHT 2011, muse, inc.
UNAUTHORIZED USE OR REPRODUCTION IS PROHIBITED.

GLOBAL LEARNING CONFERENCE CENTER
BUILDING #170
GEORGIA INSTITUTE OF TECHNOLOGY
EXECUTIVE CONFERENCE ROOM 317
PROJECT #183-2011

Georgia Tech.
Global Learning Center
A PROFESSIONAL MEETING AND LEARNING FACILITY

REVISIONS:

NO	DATE	DESCRIPTION
1		

DATE: 16 MAY 2011
FOR BID

SHEET TITLE:
**AV INFRA
STRUCTURE
DTEALS**

SHEET:
EAV1.2